

ESCAPE

TRAVELER

"THE WORLD'S MOST BEAUTIFUL TINY HOUSE" - FORBES

TRAVELER





# CONTENT

Page 03

**Price/Financing**

Page 05

**Fact sheet**

Page 06

**Pictures**

Page 07

**Sheets**

Page 09

**Quote**

Page 11

**Locations**

Page 12

**FAQ**

Page 14

**Testimonials**

Page 15

**About us**



**\$66,600 (MSRP)**

**Financing as low as: \$419/mo**

(15 year term, 15% down payment, 4% interest, monthly payment indicated)

We do deliver, the charge depends on location

**ORDER ONLINE**

**Escape Traveler**



# FINANCING

## For ESCAPE Traveler Trailer Buyers

All models are RVIA certified so are easy to finance if you qualify.

1. For cash buyers there is a discount! This averages \$2000+.
2. To finance through us, just click on the button below and fill out the application on line...simple, fast and easy. If you qualify, rates have been running on average 4-5% with 15 year financing and a 15% down payment. (Note: In order to complete a loan application, you will need a signed sales quote for the unit you plan to purchase.)
3. We do recommend contacting your bank or credit union as they know you & most likely have RV loans.

ESCAPE RV LOANS





# TRAVELER FACT SHEET

## SIZE:

25' long, (29' including hitch) x 8.5'W x 13'6"H. RVIA Certified Travel Trailer. Square footage: 269 sq/ft. - 180 sq/ft first floor, 89 sq/ft in lofts.

## MODEL:

You can see Traveler at our Factory. Just call 844.696.3722. You can see the other locations on page 3.

## WEIGHT:

10,000-12,000 lbs depending on options. Class V hitch recommended.

## TRAILER:

Custom ESCAPE steel trailer, 7,000 lb HD tandem axles, 10 ply radial tires, electric brakes, Hopkins break-away safety system, easy use leveling jacks, steel, rodent resistant belly, 2 5/16" ball hitch.

## EXTERIOR:

Pre-finished cedar lap siding and trim with steel accent and protective panels. Full light 36" glass entry door. Low-E windows, most of which open. Options: All cedar exterior available.

## INTERIOR:

Pre-finished pine T&G walls and pine trim. Options: painted drywall. Laminate flooring (option: oak hardwood). Pine solid core bathroom door, optional frosted pine full light door.

## INSULATION:

Closed cell foam using recycled products, 7.4 R value per inch. Avg. R values R22 walls, R30 floor, R40 ceiling.

## CLIMATE CONTROL OPTIONS:

Fireplace with thermostat, Split system A/C with heat pump, LP Furnace or baseboard heat. Solar Power and Off-Grid Features available

## BEDROOMS:

Upper sleeping loft with queen bed with stairway/ladder access, second sleeping loft or attic plus first floor daybed (double bed size) or first floor bedroom version.

New: Tall Loft Option! 48" upper loft ht.

## STORAGE:

Multiple cabinets of various sizes, maple cabinets std, bookshelves, build-ins, aluminum pegs, upper shelving.

## UTILITY HOOK-UPS:

Standard RV hook-ups including 30 amp electric plug, 3/4" water connection and 3" quick couple septic connection. Optional water tanks available.

## PLUMBING:

3/4" pex water lines, on demand LP hot water heater. Optional on board tanks are available.

## KITCHEN:

LP range, venting M/W, full size refrigerator, optional ice maker & stainless upgrade. Extensive maple cabinetry, stainless sink, designer faucet, butcher block kitchen table. Optional cook top and small kitchen.

## BATHROOM:

60" vanity, std. sink with Hansgrohe faucet, 60" tub/shower, Toto toilet, LED lighting, large mirror, chrome towel bars, unique aluminum pegs.

## OTHER OPTIONS:

Big screen TV with Blu-ray, washer/dryer, ceiling fan, stone counter tops, dishwasher, USB outlets, cellular shades.

Warranty: 2 years plus.



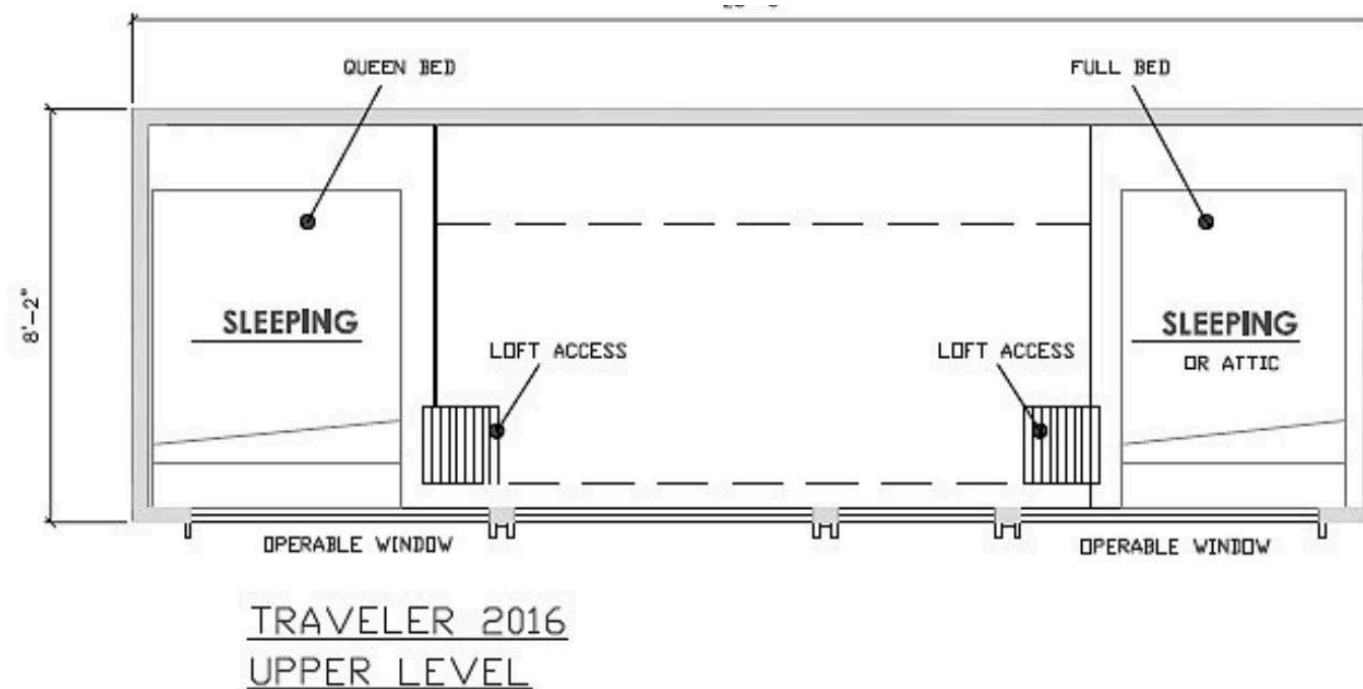
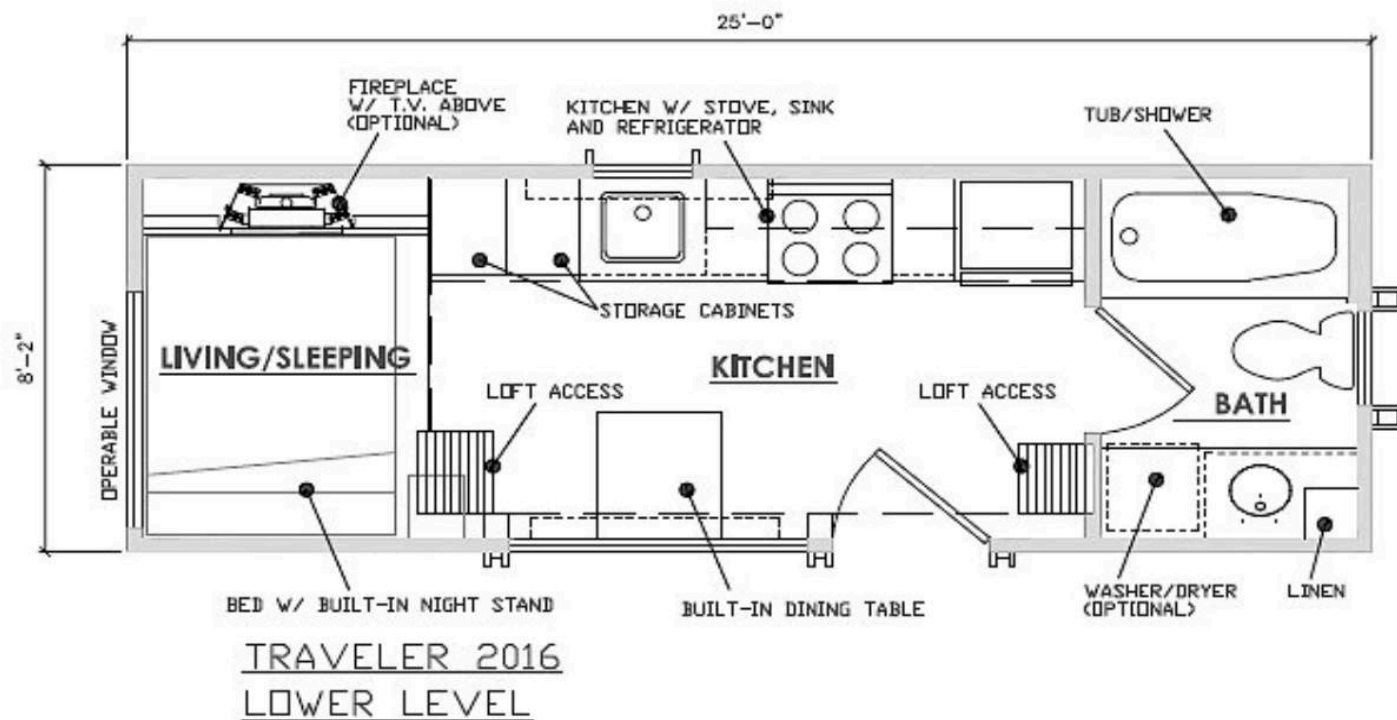



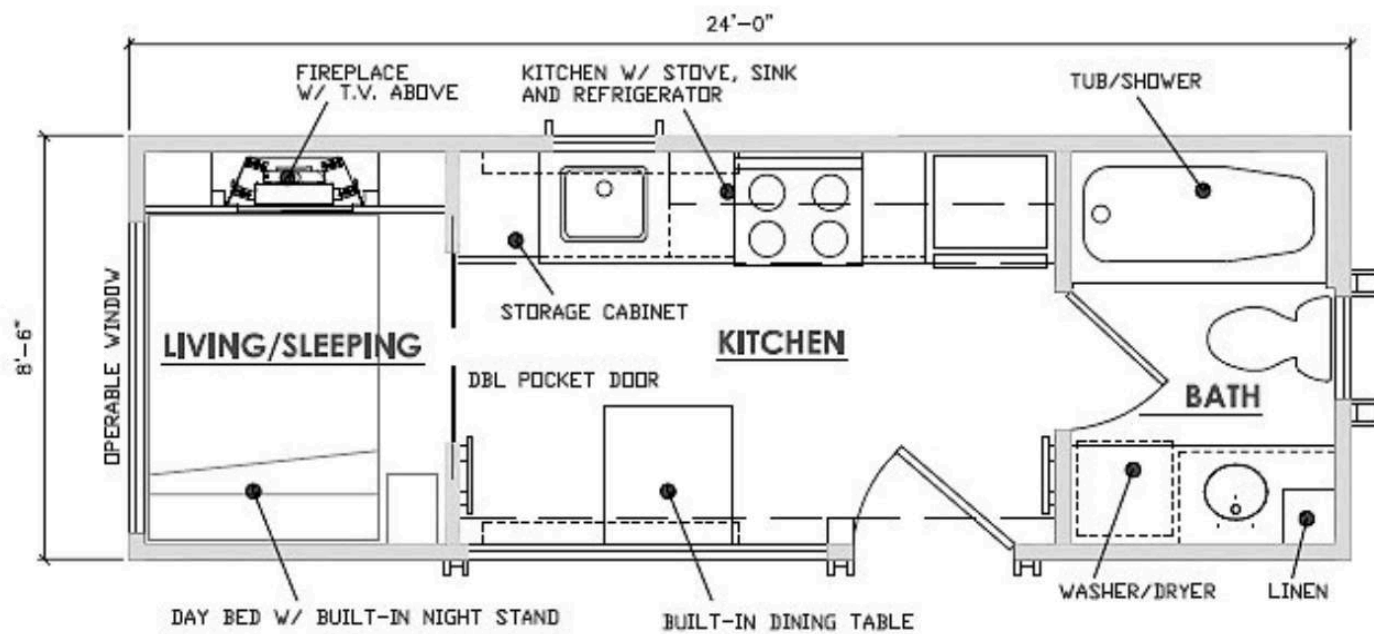

TRAVELER W/ BEDROOM  
LOWER LEVEL

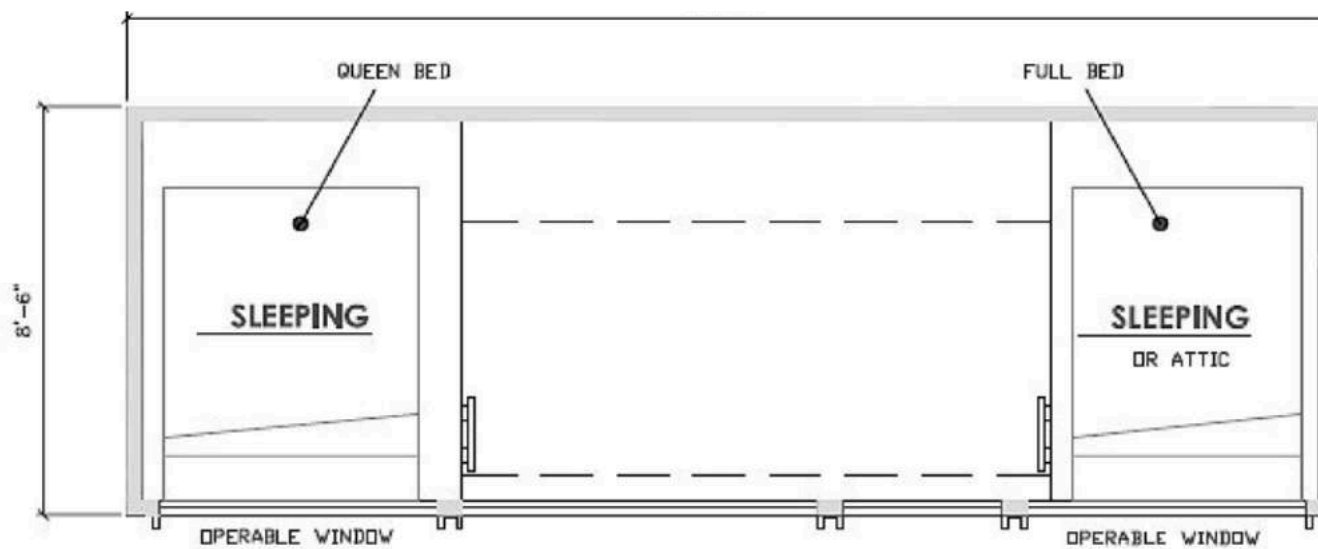

TRAVELER W/ BEDROOM  
UPPER LEVEL



## ESCAPE Traveler Pricing

\$66,600 (MSRP)

### Basic Package

- Low-E, thermopane windows
- Cedar lap siding and Corten style metal siding w/unique trim
- Panel-Loc Plus metal roofing w/40yr warranty
- Full light entry door
- Lots of storage
- Aluminum wall pegs
- Sealed Pine walls, ceiling and trim
- Solid wood bathroom door
- Laminate flooring
- Energy saving LED lighting
- On demand RV water heater
- Kitchen: maple cabinetry, laminate or butcher block tops, white Energy Star appliances, venting M/W and full size refrigerator, stainless sink and designer faucet
- Butcher block kitchen table
- Bathroom features: Vanity with single bowl sink, chrome faucet, one piece 30 x 60 fiberglass tub/shower, Toto toilet, low sohn exhaust fan, large mirror, LED lighting, chrome towel bars
- Upstairs loft bedroom features Queen bed, opening window, light
- Upstairs second loft bedroom or storage attic with opening window
- Living area features: LED lighting, daybed (full size), extensive storage, opening windows, book/storage shelf
- Baseboard heat
- Steel trailer, steel floor joists, steel rodent resistant underbelly, foam insulation, radial tires, safety hitch, leveling jacks, DOT lighting
- 2x4 Exterior wall framing, 16" OC
- ½" wall sheathing
- House wrap and window tape weatherization
- Framed roof with ½" sheathing
- Vaulted ceiling
- Closed cell foam insulation, 7.4 R value per inch-ultra quiet
- 30 amp plug
- Plumbing: Pex Manifold System
- Smoke/CO detector and fire extinguisher
- U/L approved devices and wiring
- Ceiling fan in living area
- USB outlet
- 2-20 gallon LP tanks

### Options

- Keyless Lock System (\$300)
- Vintage Oak Laminate Floor (\$1,300)
- Silestone countertops (\$2,550)
- Stainless appliances (\$1,200)
- Washer/Dryer combo (\$2,500)
- Extra Bed + Dining chairs (\$800)
- High efficiency A/C heat pump split system (\$2,800)
- Upgraded on demand water heater (\$1,350)
- Window coverings- honeycomb, designer blinds, blackout in sleeping areas (\$1,400)
- Advanced electric fireplace with cabinet (\$1,200)
- Large flat screen TV, Blu-ray player, mounts, wiring (\$940)
- Frosted full light bathroom door (\$450)
- Refrigerator ice maker (\$300)
- Gas sealed burner or Induction 2 burner cooktop (N/C)
- Vent hood/replace M/W vent (\$200)
- Special staircase with railing (\$1,300)
- Equa-Flex upgraded Ride System (\$660)
- Additional USB outlets (\$50 per)
- LP furnace 20,000 BTU (\$800)
- Exterior shower (\$500)
- Laveo Dry Flush (\$800)

### Premium Options

- First floor bedroom (\$1,500)
- Drywall with single color (\$3,800)
- Maple Interior (\$4,500)
- Oak Hardwood Floor (\$1,500)
- Cedar interior walls and trim (\$2,000)
- Dishwasher (\$1,800)
- Solar Power Pkg: Power Center, 500w of solar panels, 200Ah batteries w/pure sine wave inverter (\$5,400)
- Separett Villa composting toilet (\$1,700)



[DOWNLOAD PDF](#)



[DOWNLOAD PDF](#)

## Traveler Sales Quote

Customer Name:		Date:	
<input type="text"/>		<input type="text"/>	
Phone:	Email:	Model:	
<input type="text"/>	<input type="text"/>	<input type="text"/>	
Item:	#	Price	Extended Price
Traveler	1	\$66,600	\$66,600

### STOCK Options:

Silestone	<input type="checkbox"/>	\$2,550	<input type="text"/>
Stainless Appliances	<input type="checkbox"/>	\$1,200	<input type="text"/>
Washer/Dryer Combo	<input type="checkbox"/>	\$2,500	<input type="text"/>
LG A/C Split System	<input type="checkbox"/>	\$2,800	<input type="text"/>
Window Coverings	<input type="checkbox"/>	\$1,400	<input type="text"/>
On Demand W/H	<input type="checkbox"/>	\$1,350	<input type="text"/>
Frosted Bath Door	<input type="checkbox"/>	\$450	<input type="text"/>
USB Outlets	<input type="checkbox"/>	\$50	<input type="text"/>
LP Furnace	<input type="checkbox"/>	\$800	<input type="text"/>
Laveo Dry Flush	<input type="checkbox"/>	\$800	<input type="text"/>
Fireplace	<input type="checkbox"/>	\$1,200	<input type="text"/>
Electronics	<input type="checkbox"/>	\$940	<input type="text"/>
Ice Maker	<input type="checkbox"/>	\$300	<input type="text"/>
Vintage Oak Laminate	<input type="checkbox"/>	\$1,300	<input type="text"/>
Extra Bed/Dining chairs	<input type="checkbox"/>	\$800	<input type="text"/>
Gas/Electric Cooktop	<input type="checkbox"/>	N/C	<input type="text"/>
Vent Hood	<input type="checkbox"/>	\$200	<input type="text"/>
Special Staircase	<input type="checkbox"/>	\$1,300	<input type="text"/>
Equa-Flex Ride System	<input type="checkbox"/>	\$660	<input type="text"/>
Keyless Lock System	<input type="checkbox"/>	\$300	<input type="text"/>
Exterior Shower	<input type="checkbox"/>	\$500	<input type="text"/>

### Premium Options (these add 15-60 days of build time)

First Floor Bedroom	<input type="checkbox"/>	\$1,500	<input type="text"/>
Drywall	<input type="checkbox"/>	\$3,800	<input type="text"/>
Maple Interior	<input type="checkbox"/>	\$4,500	<input type="text"/>
Oak Hardwood Floor	<input type="checkbox"/>	\$1,500	<input type="text"/>
Cedar Interior Walls	<input type="checkbox"/>	\$2,000	<input type="text"/>
Dishwasher	<input type="checkbox"/>	\$1,800	<input type="text"/>
Solar Power- Basic	<input type="checkbox"/>	\$5,400	<input type="text"/>
Composting Toilet	<input type="checkbox"/>	\$1,700	<input type="text"/>
Options Total:			\$0
STOCK ONLY Discount*	<input type="checkbox"/>	-\$1,500	<input type="text"/>
Delivery:		TBD	<input type="text"/>

### Project Total:

\$66,600

\*STOCK ONLY discount does not apply if any Premium Options are added.

Notes:

<input type="text"/>
----------------------

Delivery Address:

<input type="text"/>
----------------------

Signature:



# ESCAPE UNITS ARE NOW NATIONWIDE

- see list under the map for units you can see



1740 20 1/2 St. Rice Lake, WI 54868, [Please email us](#)

Christiansburg, VA NEW: ESCAPE EAST Superstore: Christiansburg, VA NEW: ESCAPE EAST Superstore: Many models in Stock!

Chicago, IL New: [See the 2017 Vista just click here](#)

Las Vegas, NV New: Traveler XL at the Gold Spike, 217 N. Las Vegas Blvd...just stop by!

Asheville, NC [Please email us to see Vintage and Vista](#)

Canoe Bay, WI [Click here for an ESCAPE Classic](#)

San Francisco Bay area CA - [Please email us](#)

LA/Orange County, CA - [Please email us](#)

Atlanta, GA [Click here for a Traveler](#)

Portland/Salem Oregon's Willamette Valley Vineyard Experience

[Click here for a Vista XL](#)

Austin/San Antonio [Click here for a Vista](#)

Colorado Springs, CO [Click here for a Premiere 2 bedroom](#)

# FAQ

## **What makes ESCAPE so different?**

Design and craftsmanship. ESCAPE was designed by an award winning architectural firm, SALA Architects. ESCAPE is hand crafted in America in our own RVIA Certified factory in Rice Lake, WI. More than anything, ESCAPE is built to human scale, is incredibly comfortable and has features and comfort not found in any other RV.

## **How much does ESCAPE cost?**

Prices vary considerably by model, just choose a model. [Finance your ESCAPE here.](#)

## **What permits do I need for ESCAPE?**

For Travel Trailers, there are no permits needed for RV parks and many locations. But this does vary from place to place. Simply call your local zoning office for info about Park Model RVs.

## **How quickly can I get my ESCAPE?**

Depending on the accessories you choose, in as little as 60 days. In addition, we have dealers that have inventory for instant delivery.

## **What does delivery cost?**

We have our own trucking company so your delivery person is knowledgeable and will go over your unit when delivered.

Delivery charges depend on your location. In some cases it is free!

## **Can I buy plans for ESCAPE?**

Plans are not currently available.

## **How energy efficient is ESCAPE?**

From real world experience, ESCAPE is astonishingly efficient. [More info is here.](#)

## **Can ESCAPE operate off-grid?**

Certainly. Solar power is a good idea given the low power consumption of the unit. You can order composting or Laveo style toilets.

## **Can I customize ESCAPE?**

For information on custom designs, please [click here.](#)

## **What about storage?**

Each ESCAPE is designed to maximize space and storage possibilities. The kitchen has plenty of cabinetry and there is also storage in the bathroom.

## **Washer/Dryer hook-up?**

Yes, if you want. You can also order a washer/dryer.

## **Are there options for the Kitchen?**

Yes, just check the options sheet for the unit.

## **Does ESCAPE have a warranty?**

Absolutely. We stand behind the integrity of the unit with a full 2 year warranty but many items have much longer warranties. We have our own service people available for problems.

## **Where do I see ESCAPE...are there dealers?**

ESCAPE is sold factory-direct and through an increasing number of dealers. You can see models at our plant in Rice Lake WI and at locations around the country. Go to page 3 for other locations.

## **Is financing available?**

Finance your ESCAPE [here](#). The great news about ESCAPE is that by law it is considered an RV. Therefore you can easily finance it at any bank in the same way you would finance a car or RV.

[Continued]



# FAQ (CONT)

## **Does ESCAPE come fully constructed or do I need a contractor?**

Every ESCAPE is delivered complete with our guarantee that everything is in order, impeccably installed and ready for you to enjoy. Your ESCAPE consultant will work with you on what is needed to connect the water, sewer, power, etc.

## **Can ESCAPE be delivered anywhere?**

Yes. ESCAPE is on wheels, so it can go virtually anywhere there is a road.

## **I thought RV's had engines?**

The vast majority of RV's sold each year, over 85%, are non-motorized.

## **Does ESCAPE have tanks like a regular RV?**

ESCAPE is an RV and can have tanks.

## **What about property taxes?**

By law, ESCAPE is an RV and therefore is not subject to property tax. You simply buy a tag from the DMV every year.

## **How do I connect utilities?**

ESCAPE, like any RV, has single drops for power, water and sewer in a simple location to access and hook up. ESCAPE is designed to be simple to hook-up and simple to use.

## **Can I have ESCAPE furnished?**

Absolutely as there are furnishing options such as a couch, bed & dining chairs to name just a few items.

## **Can ESCAPE be used in extreme climates?**

Yes. The building has a very tight envelope and has done extremely well through brutal Wisconsin winters with temperatures down to -35. Pipes have not frozen and everything has functioned 100%. ESCAPE is even better in the heat thanks to great insulation.

## **How is ESCAPE heated and cooled?**

Heat comes from an LP furnace, baseboard heat, split system and/or a fireplace. You choose the option. A/C is an option and we use split systems which work great at keeping the building as cool as you would like.

## **What about maintenance of ESCAPE?**

Other than routine items, your new ESCAPE has little or no maintenance. The unit is designed to be easy on you. We do recommend recoating the unit with our stain every 3-5 years but this is strictly optional and dependent on your location.

# TESTIMONIALS

"We absolutely love our units and cannot thank you enough for everything. Your installer was great." - Kate, Asheville, NC

"The answer to the daydreams many of us share." - Silodrome

"Reinventing the rules of small living." - Cottage Life

"A mini gem." - Treehugger

"Just writing to tell you we LOVE our ESCAPE. It's even more spacious than we thought. It's really beautiful & the installers were fantastic. I can't say enough about how seamlessly everyone worked together." - Lori & Mark, NYC

"Buying an Escape home was a bit of a leap of faith for me. When I started looking for a tiny home I quickly realized that I did not want a house with a loft AND I did not want to live in a doll house. My sister found the Escape website and sent it to me and I loved the pictures and designs. The problem was that I am self employed so traveling to see the Escape homes in person just was not an option. Initially, I was very nervous about buying a house sight unseen but after talking to Dan at Escape I started to feel like it was possible. He was great to work with making sure that every detail was in the design drawings and kindly added things that I missed or never thought of! He even made me a custom bed platform so that my dogs would have plenty of room to sleep under the bed. He answered my endless questions and provided the information that I needed to do the site work before delivery. The gentlemen who delivered and set up the house were quick, efficient and lovely to work with. This house has exceeded my expectations and I am so very comfortable and happy living in my Escape home! The

construction is top quality and the wood work is beautiful. I had a great experience from start to finish." - Rebecca, Maryland.

- "We are enjoying our ESCAPE every weekend...it is fantastic" - Kevin & Nancy, Iowa

- "I can not tell you how much I appreciate both your installer and your customer service. You have gone above and beyond to help me and I am very thankful." - Amanda, North Dakota

HGTV: "Gorgeous...the ultimate escape."

BobVila.com: "Beautiful, efficiently designed and carefully crafted, ESCAPE could make your dream an affordable reality."

Huffington Post: "If it looks like a charming cabin, is structured like a charming cabin and is designed like a charming cabin, it must be a charming cabin.

- "ESCAPE was conceived as a high quality cottage, not an RV. Inspired by All-American architect Frank Lloyd Wright's celebrated attention to detail and appreciation of nature, every element of the ESCAPE has been finished to the highest quality standards, featuring cedar lap siding, LED lighting, Energy Star appliances and much more. With remarkable architectural detail and beautiful furnishings, this is hardly your standard RV, but rather an object of repose that enhances the beauty of any natural setting."

Yahoo! Homes: "...the trendiest dwelling out there..."

Midwest Home: "Charming, eco-friendly, and affordable. And, in the words of it's fans, perfect."

2014Interiors: "Immaculate and gorgeous style and design."

Blessthisstuff.com...stuff we drool about: "a beautifully crafted and efficiently designed cabin that could make your dream an affordable reality."

Inhabitat: "The ESCAPE is a symbol of modern living, where energy efficiency and minimalism are met with the comforts of good design"

Dream Home: "Immaculate and stunning layout."

ViralNova: "Compromises must be made when creating a tiny home. There's no room for a full kitchen or bathroom, but one look at ESCAPE and I would completely forget about that."

Uncrate: "Whether your using it as a woodsy cottage or a summer cabin, it's a great and suprisingly affordable option"

Gizmodo: "...so perfect, you can't even tell they're mobile...And you'd never ever, in a million years, guess that they're actually very versatile, incredibly handsome RVs."

"ESCAPE has exceeded my expectations and I am so very comfortable and happy! The construction is top quality and the wood work is beautiful. I had a great experience from start to finish." - Rebecca, Maryland

"Why buy a house at all? Stunning!" - RV Business



# ABOUT US

For the past 25 years we have been designing and building award winning Tiny homes. Rather than feeling small, dark and cramped, our designs are based on light and a feeling of openness and space. All of our units are hand-crafted in our own RVIA Certified plant and are designed for extreme climates including heavy snow, brutal cold and searing heat.

Common features in our units include panoramic windows, full kitchens, large bathrooms, large first floor bedrooms, washer/dryers, plenty of storage, full climate control, LED lighting and Off grid options. We deliver directly to customers nationwide using our own trucks & factory reps and our on-site warranty is second to none.

**Our home base is our RVIA certified plant in Rice Lake, WI. You can see most of our units, if they are not traveling, weekdays from 10a-2p by appointment. Just call 844-696-3722.**

There are now privately owned units from Miami to Seattle, New England to San Diego and most points in between. There are units on multiple islands in Hawaii. We thank the hundreds of owners who have chosen

ESCAPE including those that are using units as rentals or allow others to visit and explore.

## Real World Experience

ESCAPE has been in use for years in one of the most brutal climates in America, NW Wisconsin. Temperatures reach the 90's in the summer and stay below -30 in the winter for extended periods. Throw in ice storms, blizzards, severe thunderstorms, hail and high winds, and ESCAPE has seen it all...and performed great. ESCAPE can handle heavy snow loads and brutal cold.

As for delivery, we deliver to almost anywhere in America with our own trucking company and factory reps to ensure all goes well. This is important as only our people touch the building instead of an independent trucker. In addition, our buildings have their own leveling system so with any site that is relatively level, ESCAPE is set in a matter of minutes.

Finally, every customer can be confident that ESCAPE is built with an emphasis on eco-conscious construction and energy efficiency, including sustainable wood, high R value insulation, Low-E, thermopane windows,

custom window coverings, stainless appliances and more. ESCAPE is about making small spaces feel spacious and beautiful.

## Design

All great buildings, no matter the size, start with great design. Working in conjunction with Kelly Davis, acclaimed architect with SALA architects, we developed over the decades a style that is distinctive, graceful and wonderfully livable. The reaction has been world-wide recognition for beauty and design. Our dream is now fulfilled to make great architecture available to everyone. We're about great, livable style.

And we're not resting on our laurels. Every day our design team is working on improving ESCAPE. You might not notice the changes, but we do. Our designs feel big and that is a credit to the innovative layouts of our design team. Every inch in ESCAPE is carefully planned so that you have the most beautiful and efficient space possible. Please keep checking our [website](#) for new and exciting ideas and floor plans. As always, we welcome your comments on the perfect ESCAPE!

[Continued]

## OUR INCREDIBLE TEAM

### Construction

Great design is only the beginning. Craftsmanship is just as important. Each ESCAPE is built to the highest standards in the industry and it shows in the details and workmanship. We build in our own brand new climate controlled facility to ensure the highest quality and safety for our team.

A few ESCAPE highlights from our RVIA Inspected plant: Insulation is important and we use the best, closed cell foam that provides a 7.4 R value per inch plus seals and stiffens the building. ESCAPE materials are of the highest quality and the design elements are second to none. We give customers the choice of optional full size appliances or smaller, well designed RV style. Windows are large and Low-E to bring the outdoors in rather than feeling like you are stuck in a tunnel or a rat in a maze. The bottom of the unit is sealed with steel and coated...there is so much more and we invite you to visit our facility and see for yourself.



DAN GEORGE DOBROWOLSKI  
Founder/CEO



KELLY DAVIS, AIA  
Architect



BILL KURSHINSKY  
Drafting/design





# ESCAPE

# TRAVELER

"THE WORLD'S MOST BEAUTIFUL TINY HOUSE" - FORBES

2017

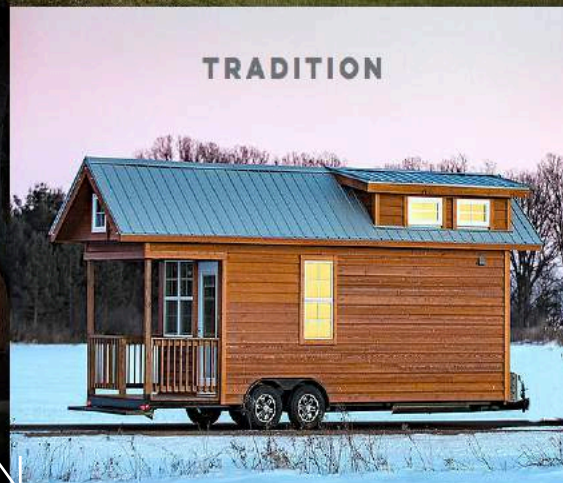

1740 20 1/2 st. rice lake, wi 54868

[sales@escapehomes.us](mailto:sales@escapehomes.us)

844-696-3722